

M·O·O·N
YACHT

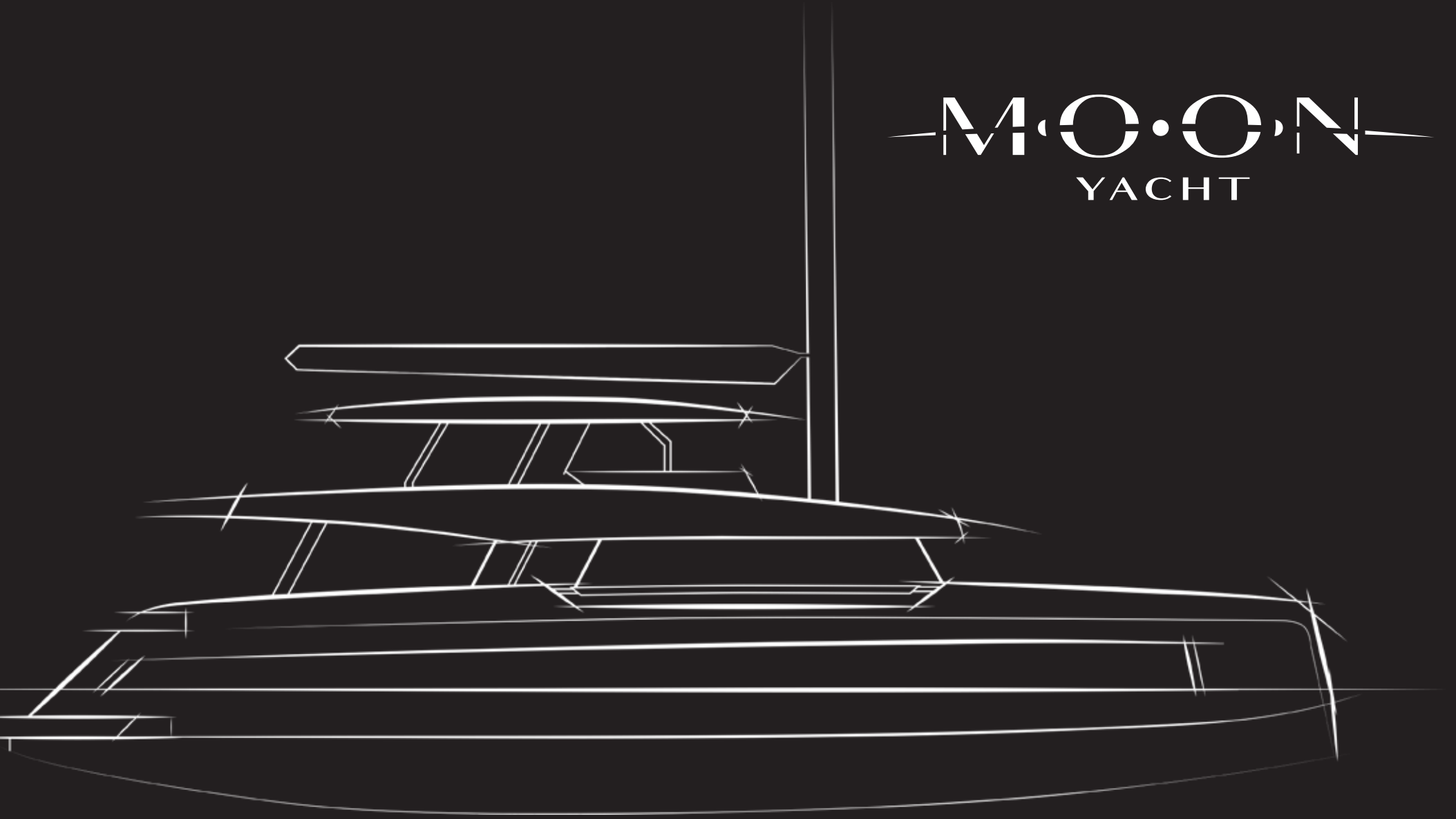

MOON 100 SAIL

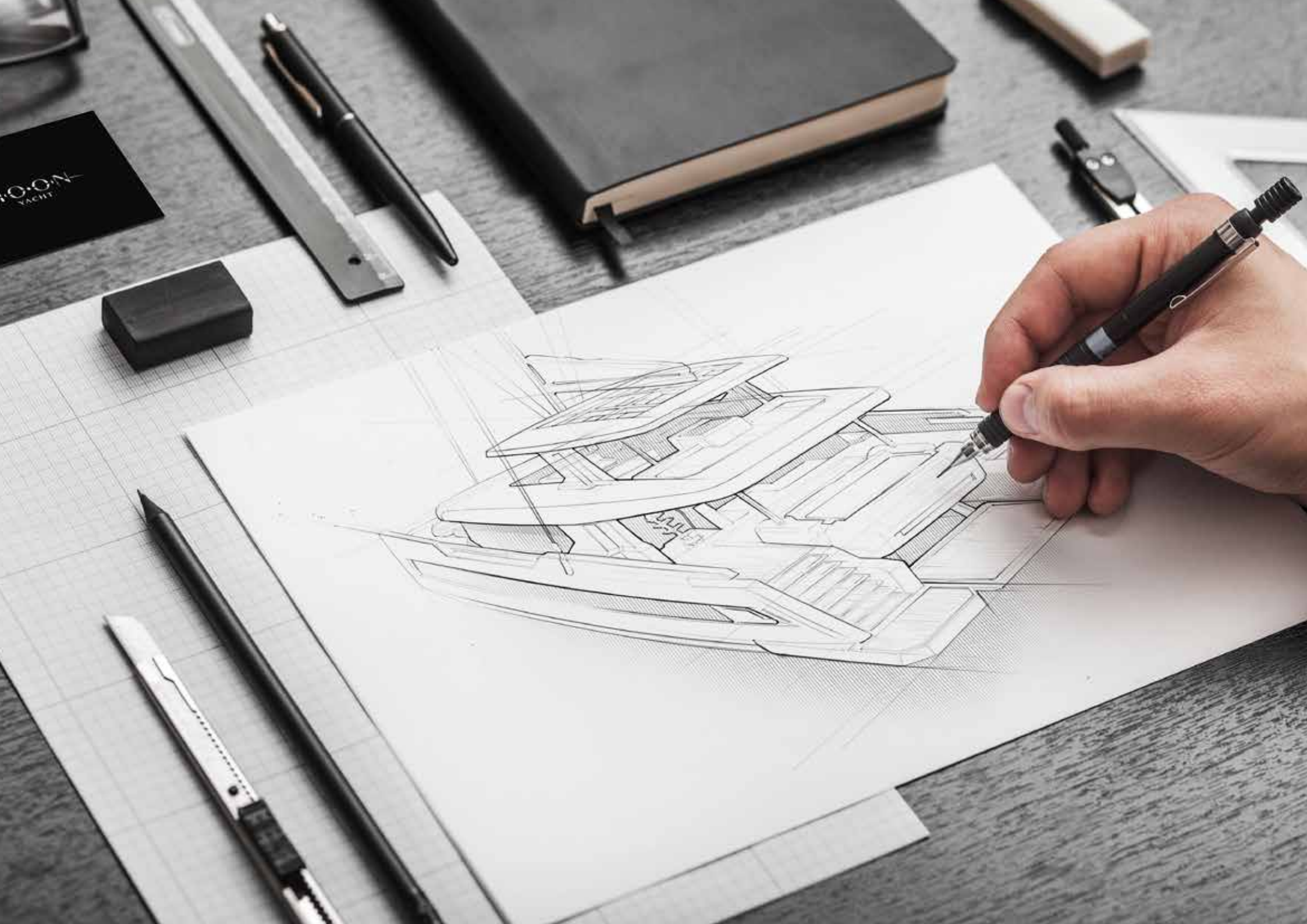

FROM THE VERY BEGINNING...

Our vision was clear – to create a truly exceptional vessel for the most discerning customers.

Months of design, brainstorming, and perfecting every detail led to the birth of something extraordinary: the MOON YACHT 100.

Moon Yacht is built on a legacy of luxury and custom design, always pushing the boundaries of what's possible.





MOON YACHT

MOON YACHT

EXTERIOR



 WALK AROUND
MOON 100 SAIL





MOON YACHT



EXTERIOR

ELEGANT LIVING AT SEA

At the stern, a spacious seating area welcomes up to 12 guests, offering the perfect setting for unforgettable moments with family and friends.

MOON YACHT





THE CROWN JEWEL: THE FLYBRIDGE

The true highlight of the MOON 100 is its expansive upper deck – the flybridge. Here, panoramic views meet fresh ocean breezes, creating an experience like no other. Unwind on plush sofas or sun loungers, sip a drink from the fully-equipped bar, or soak in the Jacuzzi as the world drifts by.





THE MAIN SALOON

Step into the main saloon – an inviting space flooded with natural light and surrounded by breathtaking sea views. Large sliding doors seamlessly connect the interior to the rear cockpit, ideal for relaxed al fresco dining.





MASTER SUITE & CABINS

Each cabin is a private sanctuary, beautifully finished with premium materials and thoughtful details.

Spacious layouts, en-suite bathrooms, and luxurious bathing lounges come standard.

The master suite can also feature a hydraulically-opening balcony – your personal oasis at sea.

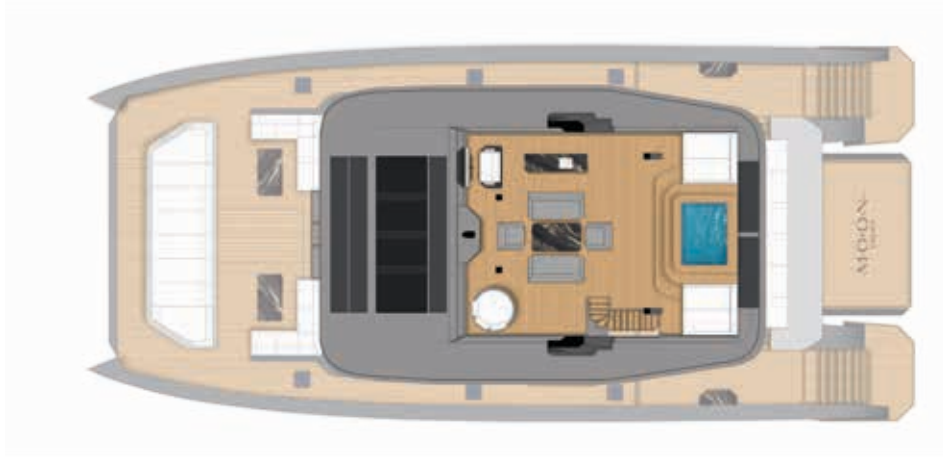

■ FLYBRIDGE (UPPER DECK)



■ MAIN DECK



■ MAIN DECK



OWNER'S VERSION - 5 CABINS



OWNER'S VERSION - 5 CABINS + GYM

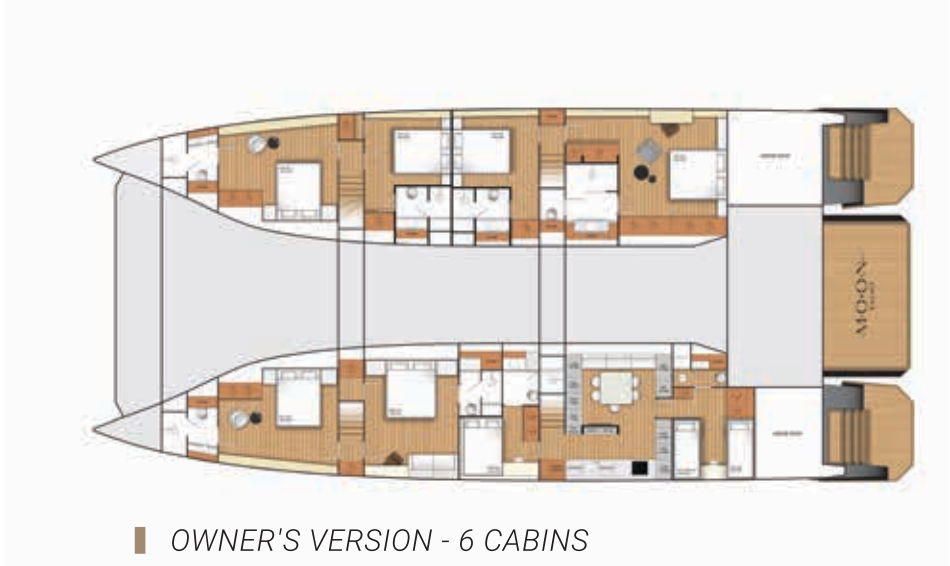

OWNER'S VERSION - 6 CABINS



SPECIFICATION MOON 100 SAIL

DESIGN	Moon Yacht
CERTIFICATION	CE class A
LOA	30 m/100ft
BEAM	13,70 m/45ft
DRAFT	2,15 m/7ft
SAIL AREA	365 sq.m
FUEL TANK	3 000 - 12 000 l
ENGINES DIESEL	2 x 320 HP/ 2 x 500 HP

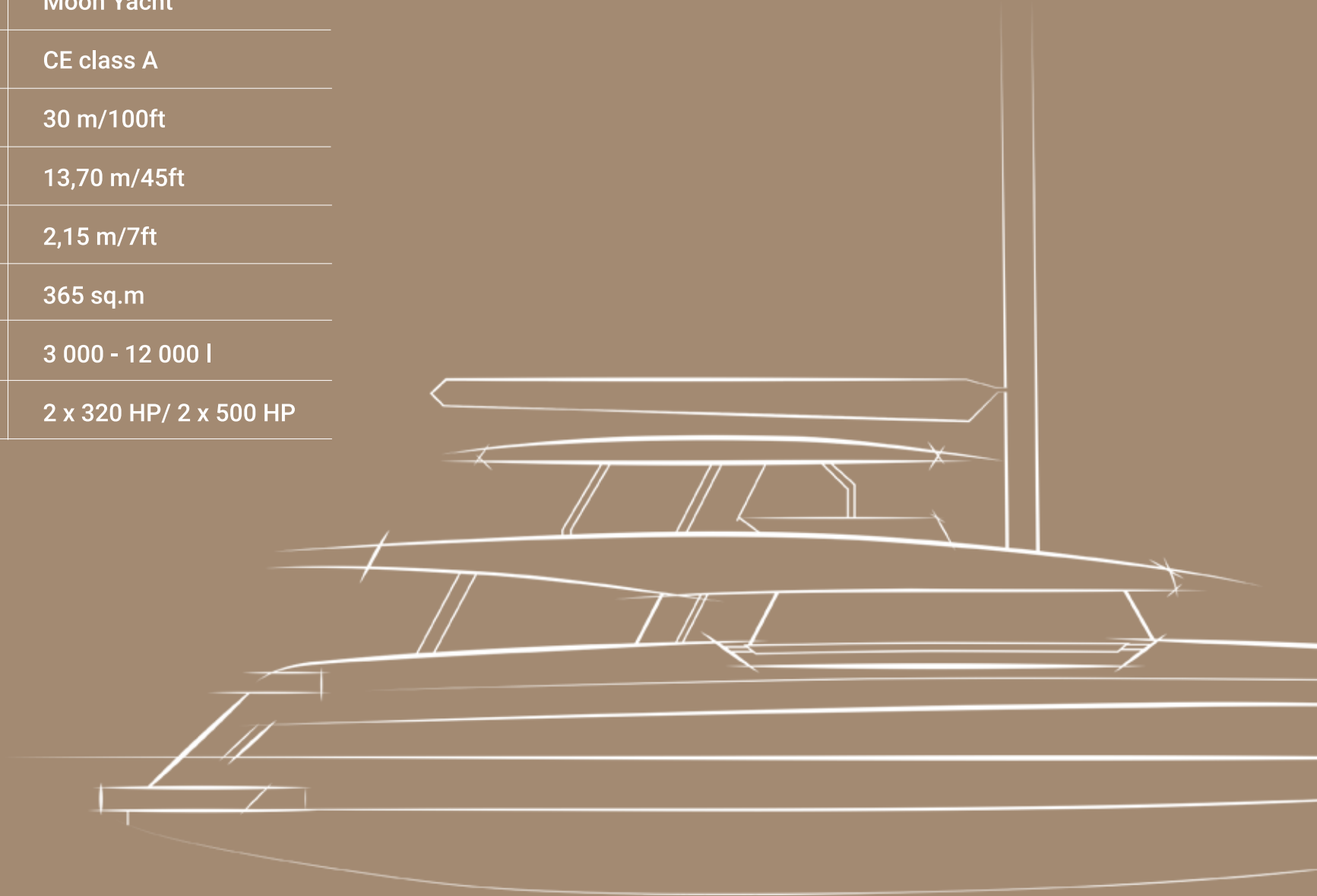

MOON YACHT





MOON YACHT

